

# Church Facility Available for Weekly Services

890 Morse Ave ~ Sacramento, CA



## PROJECT FEATURES

- Sanctuary capacity: 440
- Chapel capacity: 157
- Banquet facility capacity: 160
- Small banquet capacity: 42
- Class rooms/meeting rooms
- Abundant on-site parking
- Centrally located
- Older well established facility - mission style
- Weekend and weekday services available
- Long term commitments are encouraged.

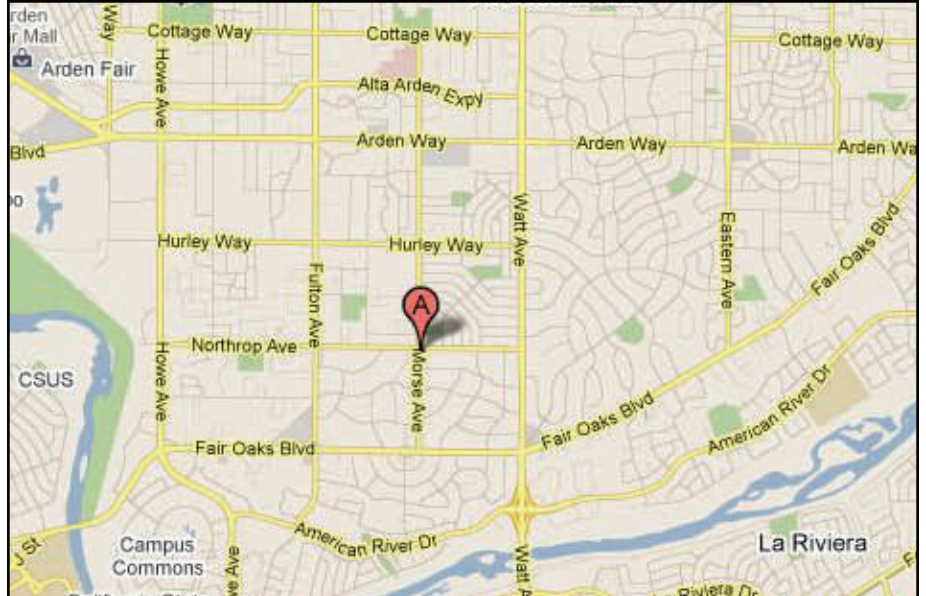

## EXCLUSIVE AGENTS

**Tom O'Neil**

DRE Lic. No. 00759276

**(916) 374-4236**

toneil@macco.org

1401 Shore Street  
West Sacramento, CA 95691

**T 916.371.9021**

**F 916.373.0655**

WWW.MACCO.ORG



**macLaughlin and CO**

Commercial And Industrial Real Estate Since 1965

The information contained herein has been carefully checked and to the best of our knowledge is correct but we assume no liability for representations as to values or for errors or omissions in this statement. Client should carefully verify the above items of income and expenses and all other information contained herein.



macLaughlin and co

# SIERRA ARDEN UNITED CHURCH OF CHRIST

890 Morse Ave • Sacramento, CA 95864  
(916) 483-5501

## East Parking Lot

Total of 29 Parking Spaces - includes 4 ♿

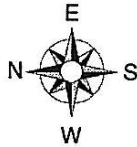
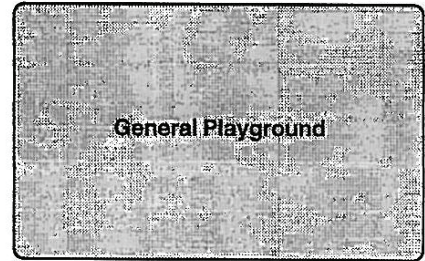

<b>Room F6</b> <i>Capacity: Not Rated</i>	Misc.	Storage
--	-------	---------

<b>Room F5</b> <i>Capacity: Not Rated</i>	Misc.	
--	-------	--

<b>Food Closet</b>		
--------------------	--	--

<b>Room F4</b> Room Size: 22 ft. x 24 ft. Capacity - Classroom 26 or Meetings: 35		
---	--	--

<b>Room F3</b> Church Library		
----------------------------------	--	--

<b>Room F2</b> Room Size: 14 ft. x 24 ft. Capacity - 22		
---	--	--

<b>Room F1</b> Room Size: 26 ft. x 24 ft. Capacity - Dining: 42 or Meetings: 69		
---	--	--

<b>Chapel</b> Room Size 25 ft. x 44 ft. Capacity - 157	
--	--

Upstairs Loft	<b>Founders Hall Kitchen</b>
Chapel Narthex	

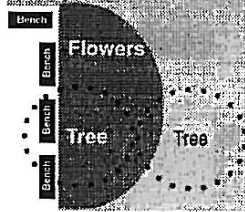
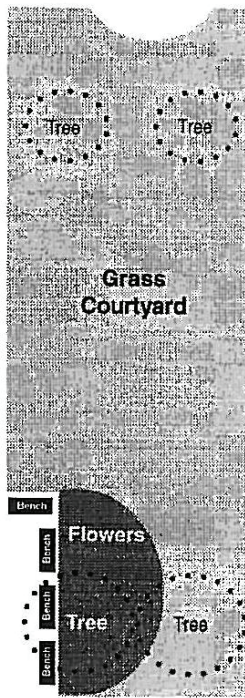
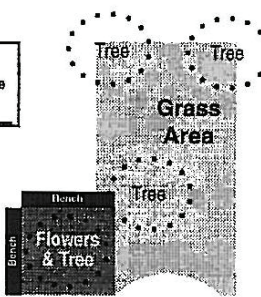

<b>Pilgrim Hall Kitchen</b>	Storage
-----------------------------	---------

<b>Pilgrim Hall</b> Room Size: 49 ft. x 49 ft. Capacity - Dining: 160 or Concerts: 342
--

<b>Room C</b> Room Size: 16 ft. x 23 ft. Capacity - 18
--

Child's Toilet
----------------

<b>Room B</b> Room Size: 16 ft. x 23 ft. Capacity - 18
--

<b>Room A</b> Room Size: 21 ft. x 23 ft. Capacity - 24
--

Child's Toilet
----------------

<b>Nursery</b>
----------------



<b>Main Entry (Narthex)</b>
Room Size: 40 ft. x 65 ft. Capacity - 440
<b>Sanctuary</b>

Men's Restroom	<b>Mayflower Room</b> Rooms Size: 29 ft. x 16 ft. Capacity - 31
Women's Restroom	

Women's Restroom	<b>Main Church Office &amp; Meeting Room</b>	Office Manager	Pastor's Office
Unisex Restroom ♿			

Northrop Avenue

Morse Avenue

## West Parking Lot

Total of 32 Parking Spaces - includes 3 ♿