



macLaughlin and co

Commercial And Industrial Real Estate Since 1965

FOR LEASE

Project Sq. Ft.: 36,800 SF

1724 Junction Avenue, San Jose, California

1724 Junction Suite D 3,276 SF .65/NNN



PROJECT FEATURES

- 200 Amps Power
- 15' Clear Height
- Grade Level Loading
- Parking: 1 per 1,000.
- Easy Access to I-880/Hwy. 101
- I-880 Visibility
- 25% office buildout

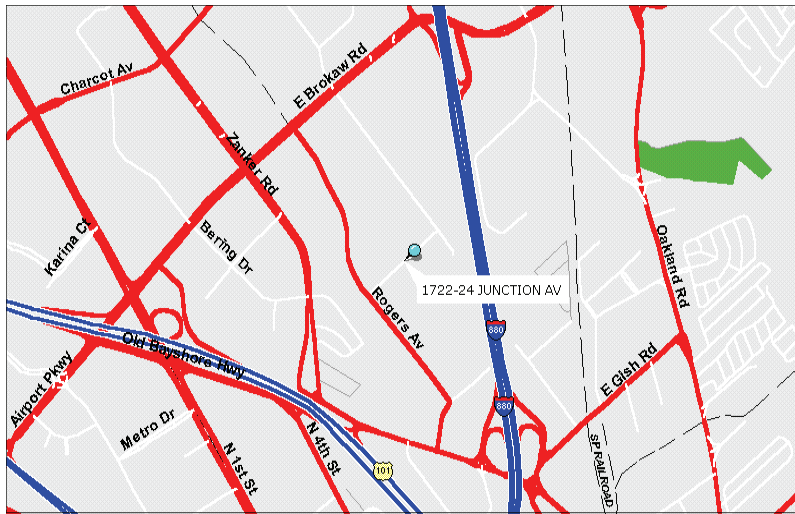

Phone: 408-436-1441
916-371-9021
Fax: 408-436-1753
916-373-0655

EXCLUSIVE AGENT

James B. MacLaughlin
 DRE Lic. #00944675
 (916) 374-4232
 jmacLaughlin@macco.org

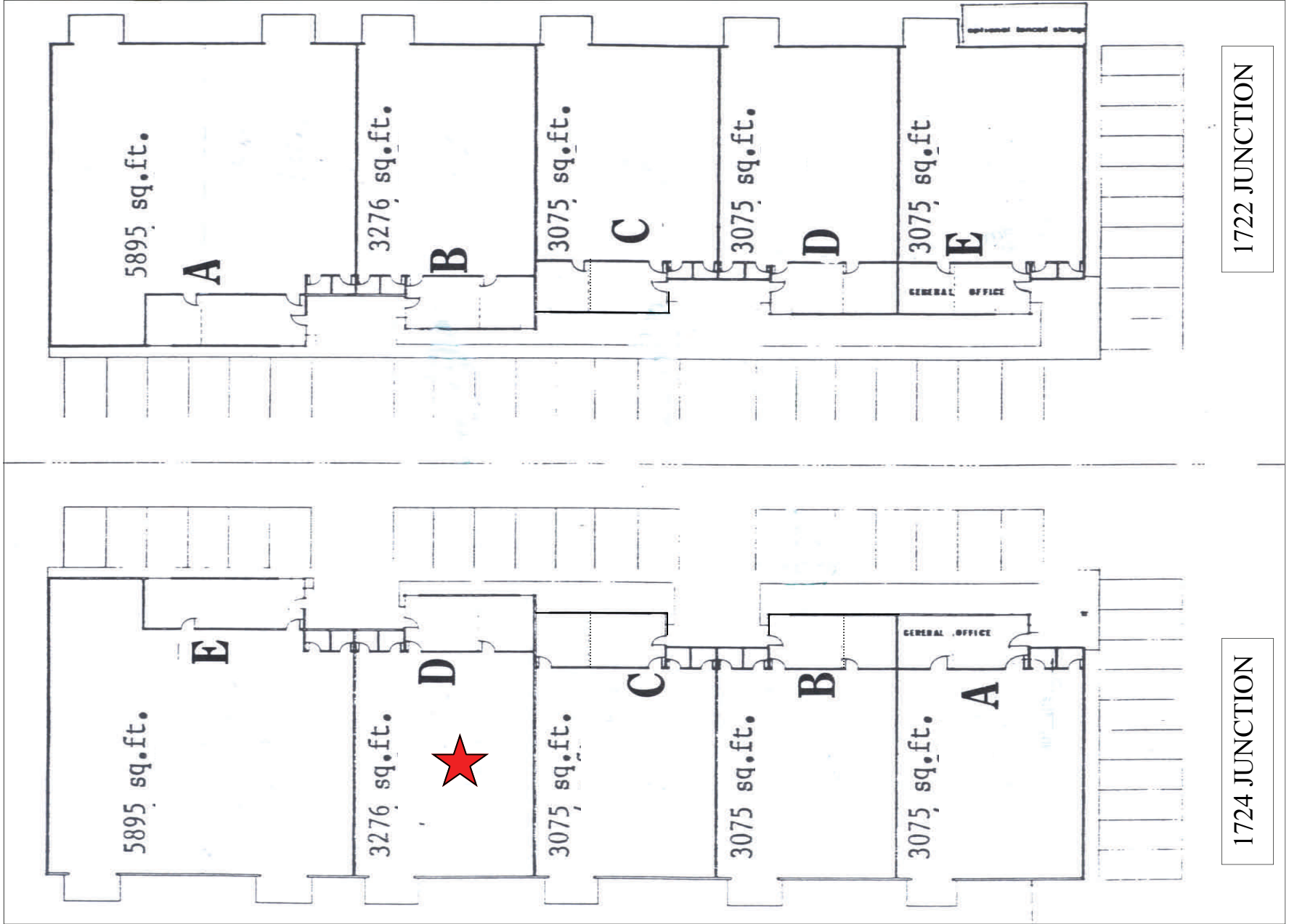



1724 Junction Ave Suite D

