

FOR LEASE

1140 TARA COURT, ROCKLIN, CA



Suite A Features:

- Tenant improvements available
- 22' clear height
- Fully sprinklered
- 2 grade level doors
- 500 sq. ft. office
- Power: 120/208V 3-Phase

Space Available

Suite A: 7,600 sq. ft.
Asking Rate: \$.40/Gross

Exclusive Agents

Tom MacLaughlin
(916) 374-4233
thmac@macco.org
DRE Lic. No. 00690406

Debbie Regan
(916) 374-4225
dregan@macco.org
DRE Lic. No. 01703752

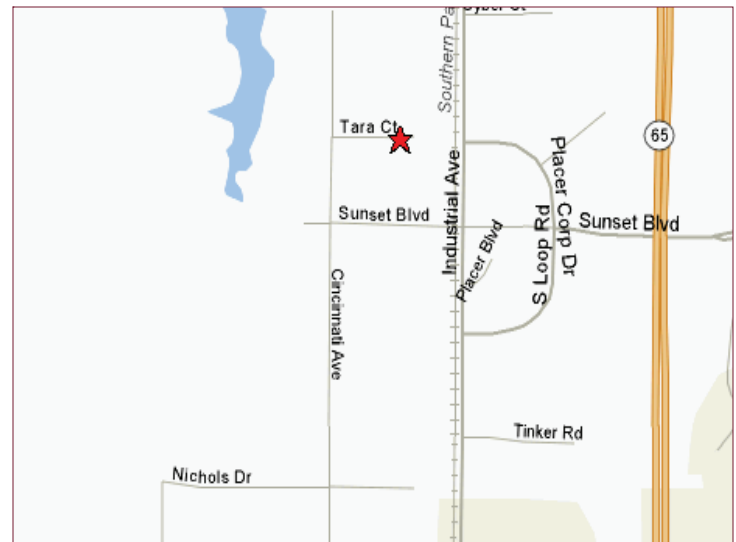

macLaughlin and CO
Commercial And Industrial Real Estate Since 1965

1401 Shore St.
W. Sacramento, CA
Phone: 916-371-9021
Fax: 916-373-0655

To view all of our available properties go to www.macco.org

The information contained herein has been carefully checked and to the best of our knowledge is correct but we assume no liability for representations as to values or for errors or omissions in this statement. Client should carefully verify the above items of income and expenses and all other information contained herein.



maclaughlin and co

Site Plan

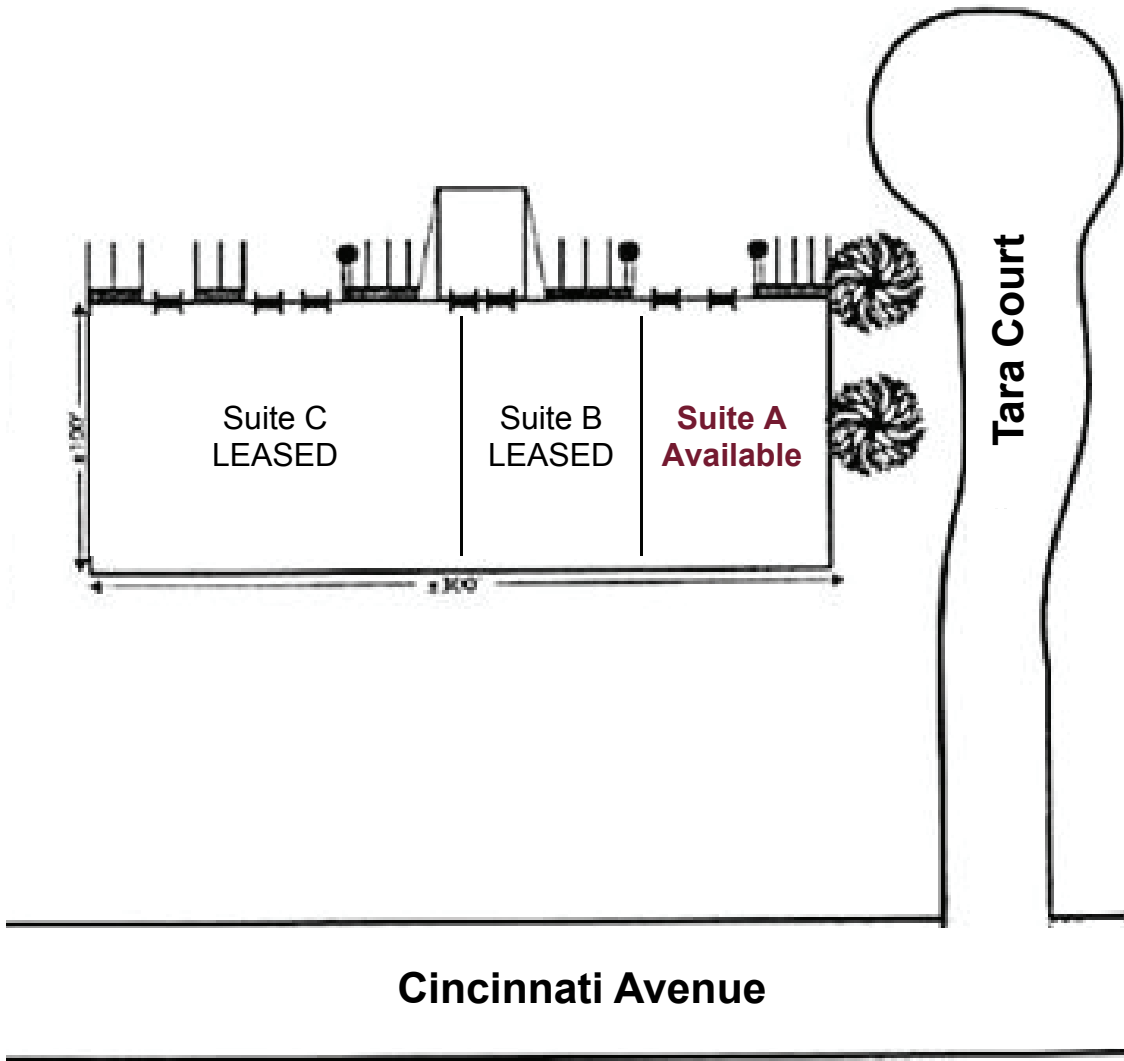



Aerial Photo



Parcel Map

