

# AVAILABLE FOR LEASE

11367 SUNRISE GOLD CIRCLE, RANCHO CORDOVA, CA

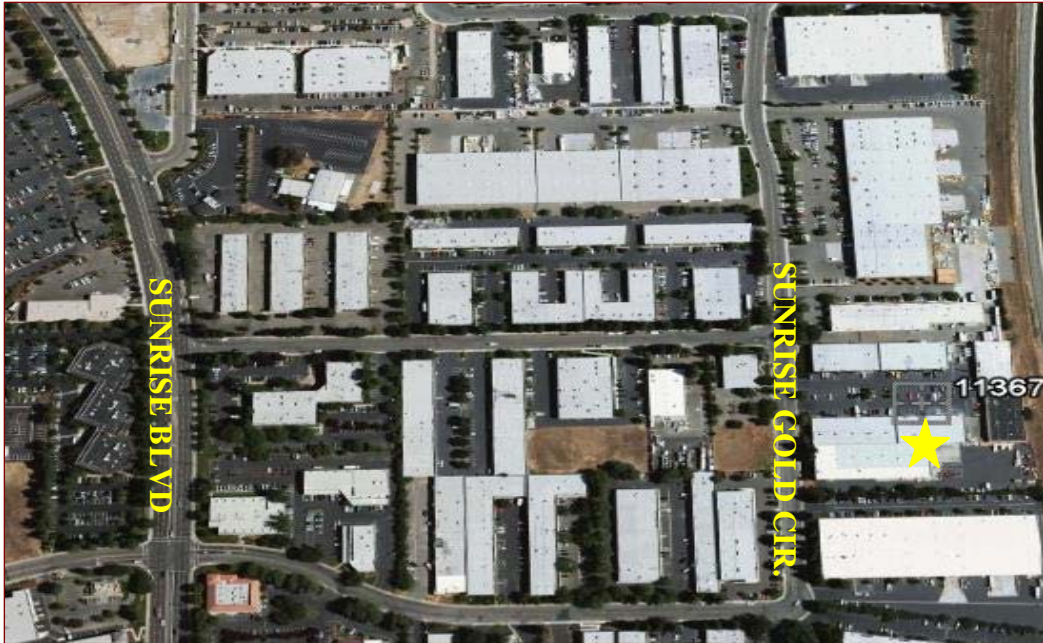

## 5% Commission To Procuring Broker

### LEASING INFORMATION:

Available SF: 5,920 Sq. Ft.

Divisible To: 2,960 Sq. Ft.

-----  
Asking Rent: \$0.35/PSF/NNN

### PROJECT FEATURES:

- 16' CLEAR HEIGHT
- AMPLE POWER
- GRADE LEVEL DOOR LOADING
- TENANT IMPROVEMENTS AVAILABLE
- EASY ACCESS TO FREEWAYS
- GREAT RANCHO CORDOVA LOCATION

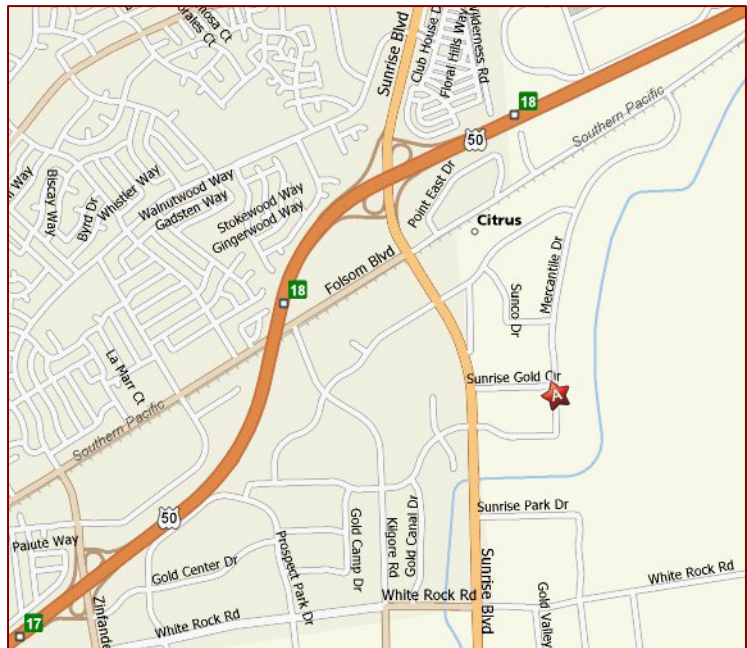

### For Information Contact:

**Thomas H. MacLaughlin**  
DRE Lic. No 00690406

**Debbie Regan**  
DRE Lic. No. 01703752

1401 Shore Street  
W. Sacramento, CA 95691  
Phone: 916.371.9021  
Fax: 916.373.0655

The information contained herein has been carefully checked and to the best of our knowledge is correct but we assume no liability for representations as to values or for errors or omissions in this statement. Client should carefully verify the above items before making any investment decisions.



**macLaughlin and co**

Commercial and Industrial Real Estate Since 1965

**11367 Sunrise Gold Circle**  
**Rancho Cordova, California**

**FLOOR PLAN**

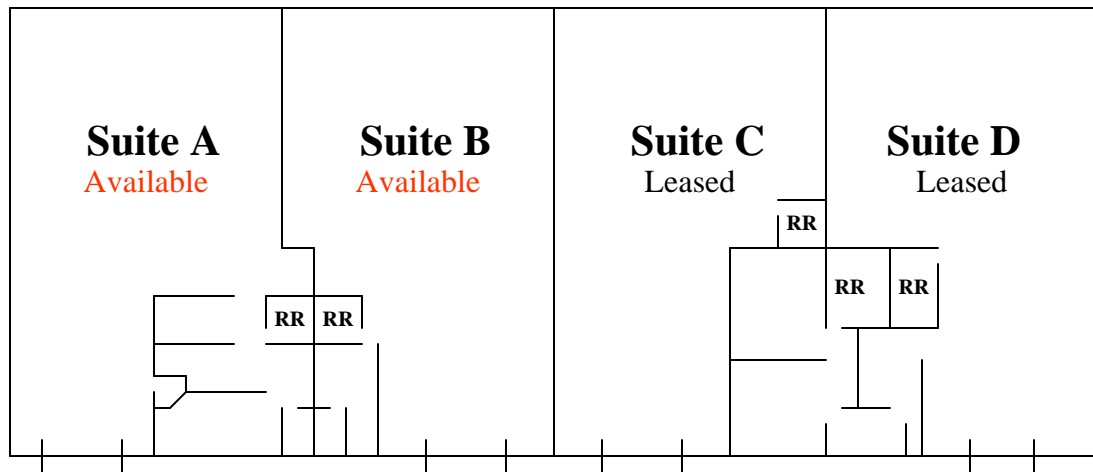

**Each Unit Is Total SF +/-2,960 SF**

**Office SF:**

**Suite A: 500 SF**

**Suite B: 240 SF**

**Suite C: 0 SF**

**Suite D: 864 SF**

Not To Scale